

POWERFUL MAGNETIC SEPARATORS

Model PCMP POWERFUL MAGNETIC PIPE

PCMP-300W

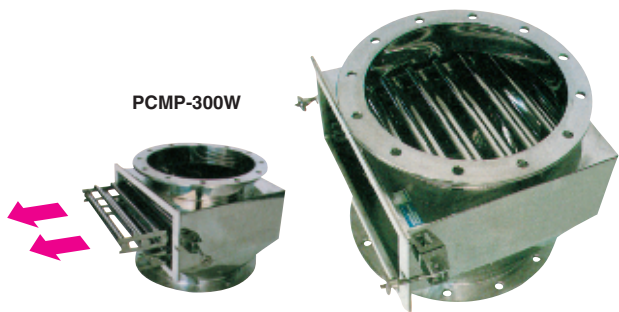

An example of fabrication of various types

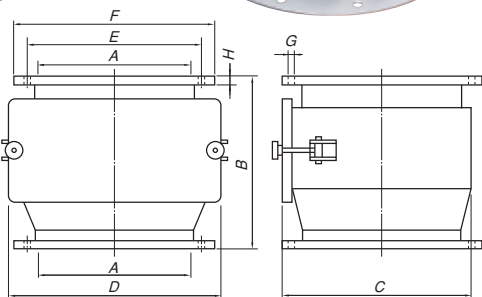
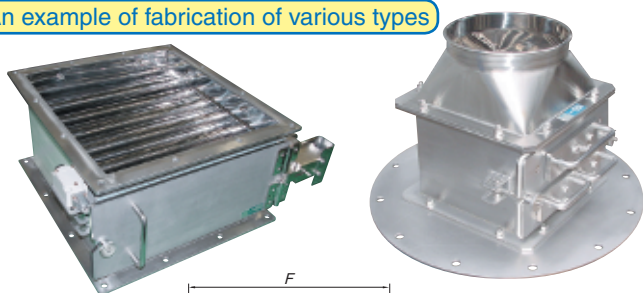

An example of PCMP automatic discharge type

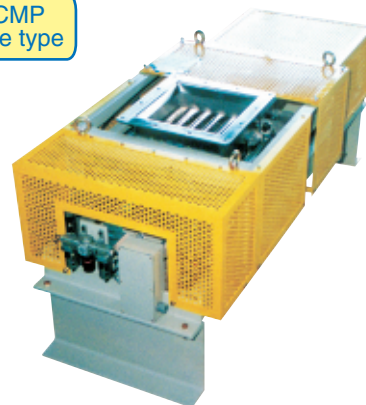

[Application]

These pipes are installed on the falling side of pneumatic feed lines and pipe passages having a relatively large diameter to remove iron from flowing powder and granular materials of food raw materials and chemical powder.

[Features]

- Models of various sizes are available to meet various diameters of pipes on which they are installed and required processing capacity.
- Powerful magnetic bars having a surface magnetic flux density of 0.8 T (8,000 G) or 1 T (10,000 G) or over are built in, that enables efficient collection of iron from flowing granular materials.
- A heat-resistant powerful version that can maintain its strong magnetic force without significant deterioration when used continuously in fluid up to 240°C is also available.
- Since permanent magnets that maintain a strong magnetic force almost perpetually are used, the running cost can be reduced significantly.
- An example of usage : Spice raw materials, gunpowder, chemicals

Gentle removal of iron from powder, fine and coarse particles without damaging or denaturing them.



Powerful type

[mm (in)]

Model	Material	Magnetic Bar		Processing Capacity	Dimensions								Working Temperature	Mass	
		Stage	Qty		Surface max. magnetic flux density	A	B	C	D	E	F	G			H
PCMP-200W	SUS 304	2	9	0.8T (8000G)	6m ³ /h	φ 220 (8.66)	360 (14.1)	269 (10.5)	296 (11.6)	280 (11.0)	320 (12.6)	φ 18 (0.70) × 8 (0.31)	8 (0.31)	Upper limit 80°C (176°F)	24kg/ 52 lb
PCMP-250W			11		10m ³ /h	φ 270 (10.6)	380 (14.9)	319 (12.5)	346 (13.6)	345 (13.5)	385 (15.2)				30kg/ 66 lb
PCMP-300W			13		14m ³ /h	φ 320 (12.6)	410 (16.1)	369 (14.5)	396 (15.5)	390 (15.3)	430 (16.9)				35kg/ 77 lb
PCMP-350W			15		18m ³ /h	φ 370 (14.5)	450 (17.7)	419 (16.5)	446 (17.5)	435 (17.1)	480 (18.9)				41kg/ 90 lb
PCMP-400W			17		24m ³ /h	φ 420 (16.5)	470 (18.5)	469 (18.4)	496 (19.5)	495 (19.4)	540 (21.2)				47kg/ 103 lb

*Flanges of special dimensions are also available according to the specifications of connection. *A type having the magnet part made of SUS316 and a type having one-stage magnet rack are also available.

Heat-resistant powerful type

[mm (in)]

Model	Material	Magnetic Bar		Processing Capacity	Dimensions								Working Temperature	Mass	
		Stage	Qty		Surface max. magnetic flux density	A	B	C	D	E	F	G			H
PCMP-T200W	SUS 304	2	9	0.8T (8000G)	6m ³ /h	φ 220 (8.66)	360 (14.1)	269 (10.5)	296 (11.6)	280 (11.0)	320 (12.6)	φ 18 (0.70) × 8 (0.31)	8 (0.31)	Upper limit 240°C (464°F)	24kg/ 52 lb
PCMP-T250W			11		10m ³ /h	φ 270 (10.6)	380 (14.9)	319 (12.5)	346 (13.6)	345 (13.5)	385 (15.2)				30kg/ 66 lb
PCMP-T300W			13		14m ³ /h	φ 320 (12.6)	410 (16.1)	369 (14.5)	396 (15.5)	390 (15.3)	430 (16.9)				35kg/ 77 lb
PCMP-T350W			15		18m ³ /h	φ 370 (14.5)	450 (17.7)	419 (16.5)	446 (17.5)	435 (17.1)	480 (18.9)				41kg/ 90 lb
PCMP-T400W			17		24m ³ /h	φ 420 (16.5)	470 (18.5)	469 (18.4)	496 (19.5)	495 (19.4)	540 (21.2)				47kg/ 103 lb

*Flanges of special dimensions are also available according to the specifications of connection. *A type having the magnet part made of SUS316 and a type having one-stage magnet rack are also available.

Super powerful type

[mm (in)]

Model	Material	Magnetic Bar		Processing Capacity	Dimensions								Working Temperature	Mass	
		Stage	Qty		Surface max. magnetic flux density	A	B	C	D	E	F	G			H
PCMP-A200W	SUS 304	2	9	1T (10000G)	6m ³ /h	φ 220 (8.66)	360 (14.1)	269 (10.5)	296 (11.6)	280 (11.0)	320 (12.6)	φ 18 (0.70) × 8 (0.31)	8 (0.31)	Upper limit 80°C (176°F)	24kg/ 52 lb
PCMP-A250W			11		10m ³ /h	φ 270 (10.6)	380 (14.9)	319 (12.5)	346 (13.6)	345 (13.5)	385 (15.2)				30kg/ 66 lb
PCMP-A300W			13		14m ³ /h	φ 320 (12.6)	410 (16.1)	369 (14.5)	396 (15.5)	390 (15.3)	430 (16.9)				35kg/ 77 lb
PCMP-A350W			15		18m ³ /h	φ 370 (14.5)	450 (17.7)	419 (16.5)	446 (17.5)	435 (17.1)	480 (18.9)				41kg/ 90 lb
PCMP-A400W			17		24m ³ /h	φ 420 (16.5)	470 (18.5)	469 (18.4)	496 (19.5)	495 (19.4)	540 (21.2)				47kg/ 103 lb

*Flanges of special dimensions are also available according to the specifications of connection. *A type having the magnet part made of SUS316 and a type having one-stage magnet rack are also available.

MAGNETIC TOOLS & EQUIPMENT FOR FEEDING OPERATION
LIFTING MAGNET
MAGBORER - CHIP & SLUDGE CONVEYANCE EQUIPMENT
ENVIRONMENTAL EQUIPMENT
MAGNETIZER AND DEMAGNETIZER
MAGNETIC SEPARATORS
POWERFUL MAGNETIC SEPARATORS
MEASURING TOOLS
MEASURING INSTRUMENTS
MAGNETIC MATERIALS