

PERMANENT MAGNETIC CHUCKS

Model RMWH-A-H RECTANGULAR TYPE

ELECTROMAGNETIC CHUCK CONTROLLERS



RMWH-1018A-H

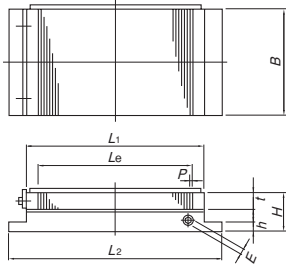

[Application]

These chucks can be used for a wide range of applications such as securing very small workpieces, grinding, electric discharge machining. They can be used in fluid.

[Features]

Compared with Model RMWH-C, these chucks are capable of holding thinner and smaller workpieces.

PERMANENT MAGNETIC CHUCKS

Model	Nominal Dimensions	Top Plate				Pole Pitch P	Bottom Plate			Height H	Handle Hole E	Mass
		B	L ₁	L _e	t		B	L ₂	h			
RMWH-1018A-H	105(4.13) × 175(6.89)	100(3.93)	175(6.89)	143(5.63)	18(0.70)	1.5(0.5+1) (0.05)	100(3.93)	191(7.52)	10(0.39)	40(1.57)	8(0.31)	5.5kg/12 lb
RMWH-1325A-H	130(5.11) × 250(9.84)	130(5.11)	250(9.84)	209(8.22)			130(5.11)	266(10.4)				10kg/22 lb
RMWH-1530A-H	150(5.90) × 300(11.8)	150(5.90)	300(11.8)	257(10.1)			150(5.90)	316(12.4)				14kg/30 lb
RMWH-2035A-H	200(7.87) × 350(13.7)	200(7.87)	350(13.7)	299(11.7)			200(7.87)	366(14.4)				22kg/48 lb

※The handle is a hexagonal wrench key.

[mm(in)]

BLOCKS FOR MC

Model RMWH-2F DOUBLE-FACE HOLDING TYPE

VACUUM CHUCKS

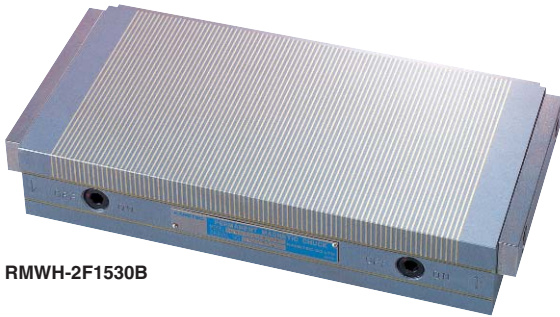

RMWH-2F1530B

Both sides are magnetic.



Front face



Back face

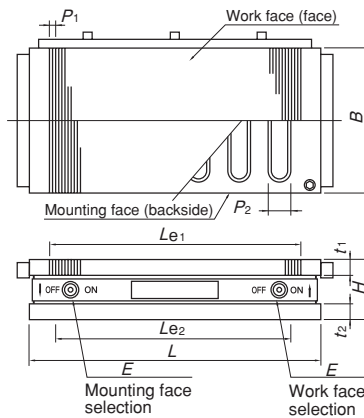

[Application]

Suitable for grinding and electric discharge machining of workpieces of various thicknesses and sizes.

[Features]

- A micro pole-to-pole pitch on the chuck work face produces effective holding power on thin and small workpieces.
- A powerful permanent magnetic attractive face with the chuck mounting face that can also be turned on and off. Thus, no mechanical clamping is required for installation.
- Can be used in fluid.
- The select handle is of side insert type and can be removed when it is not used after ON/OFF operation.

PROMELTA SYSTEM

SINE BAR CHUCKS

MAGNETIC BLOCKS

Model	Nominal Dimensions	Top Plate				Face Plate Pole P ₁	Bottom Plate		Bottom Plate Pole P ₂	Height H	Handle Hole E	Mass
		B	L	L _{e1}	t ₁		L _{e2}	t ₂				
RMWH-2F1530B	150(5.90) × 300(11.8)	150(5.90)	300(11.8)	265(10.4)	18(0.70)	3(1+2) (0.11)	222(8.74)	13(0.51)	20(2+18) (0.78)	55(2.16)	8(0.31)	17.5kg/38 lb

※The handle is a hexagonal wrench key.

[mm(in)]

WORKING TOOLS

Model RTH THIN RECTANGULAR TYPE

MEASURING TOOL HOLDERS

MAGNETIC HOLDERS

MAGNETIC TOOLS



RTH-1118A

[Features]

- Very thin and light weight chucks designed for wire electric discharge machining and high speed light duty grinding.
- Made of stainless steel for rust prevention and complete waterproof construction. The magnetic force can of course be turned on and off.
- All models are as thin as 20 mm.

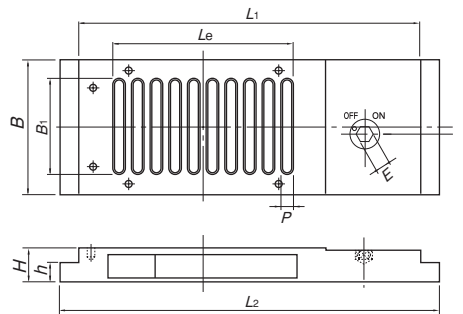

The same chuck but made of stainless steel is available to be manufactured on request.

Model	Nominal Dimensions	Top Plate			Pole Pitch P	Bottom Plate		Height H	Handle Hole E	Mass	
		B	L ₁	L _e		L ₂	B				
RTH-713	70(2.75) × 130(5.11)	70(2.75)	180(7.08)	97(3.81)	10(1+5+1+3) (0.39)	200(7.87)	70(2.75)	10(0.39)	20(0.78)	8(0.31)	2 kg/4.4 lb
RTH-1118	110(4.33) × 180(7.08)	110(4.33)	230(9.05)	147(5.78)		250(9.84)	110(4.33)				3.7kg/8.1 lb
RTH-1515	150(5.90) × 150(5.90)	150(5.90)	200(7.87)	117(4.60)		220(8.66)	150(5.90)				4.5kg/9.9 lb

[mm(in)]