

PERMANENT MAGNETIC CHUCKS

Model RMCW THIN AND CIRCULAR TYPE

ELECTROMAGNETIC CHUCK CONTROLLERS
PERMANENT MAGNETIC CHUCKS



RMCW-50B

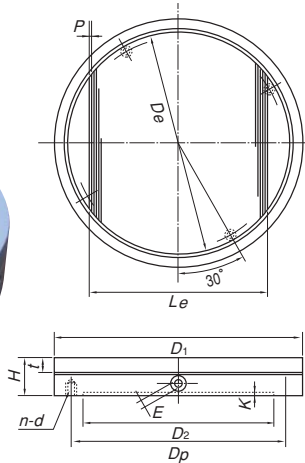

[Application]

Suitable for grinding a wide range of workpieces, from small and large, to thin and thick workpieces. Since these chucks are thin, they can be used in a wide range of applications including securing workpieces temporarily.

[Features]

- Thin; 43 mm to 60 mm.
- Micro pole pitch; can be used with any sizes of workpieces, small and large workpieces and thin and thick workpieces.
- The handle is a hexagonal wrench key. It can be operated with light turning, requiring only a half turn for magnetic force ON and OFF.
- The ON-OFF handle can be partially set to provide a weak magnetic force for easy positioning of workpieces, and temporary securing of parts.

[mm (in)]

Model	Nominal Dimensions	Top Plate			Pole pitch P	Bottom Plate				Face Plate Thickness L ₂	Height H ₂	Handle Hole Hexagon 8 (0.31)	Mass
		D ₁	D _e	L _e		D ₂	K	D _p	n				
RMCW-6B	60 (2.36)	60 (2.36)	50 (1.96)	35 (1.37)	3(1+2) (0.11)	30 (1.18)	2 (0.07)	44 (1.73)	2 (0.07)※1	M 6 (0.23)	18 (0.70)	43 (1.69)	1kg/ 2 lb
RMCW-10B	100 (3.93)	100 (3.93)	90 (3.54)	65 (2.55)		60 (2.36)	3 (0.11)	76 (2.99)	3 (0.11)※1				2.5kg/ 6 lb
RMCW-13B	125 (4.92)	125 (4.92)	99 (3.89)	66.5 (2.61)		80 (3.15)	2 (0.07)	112 (4.40)	4 (0.15)				4kg/ 9 lb
RMCW-16B	160 (6.29)	160 (6.29)	134 (5.27)	87.5 (3.44)		125 (4.92)		140 (5.51)		M 8 (0.31)			6.5kg/ 14 lb
RMCW-20B	200 (7.87)	200 (7.87)	172 (6.77)	120 (4.72)		160 (6.29)		180 (7.08)					10kg/ 22 lb
RMCW-25B	250 (9.84)	250 (9.84)	220 (8.66)	185 (7.28)		200 (7.87)	224 (8.81)	M10 (0.39)	15kg/ 33 lb				
RMCW-30B	300 (11.8)	300 (11.8)	272 (10.7)	219.5 (8.64)		230 (9.05)	260 (10.2)		M12 (0.47)	25kg/ 56 lb			
RMCW-40B	400 (15.7)	400 (15.7)	370 (14.5)	320 (12.6)		315 (12.4)	355 (13.9)	45 (1.77)		44kg/ 98 lb			
RMCW-50B	500 (19.6)	500 (19.6)	466 (18.3)	359 (14.1)		350 (13.7)	400 (15.7)		60 (2.36)	92kg/202 lb			
RMCW-60B	600 (23.6)	600 (23.6)	566 (22.2)	456 (17.9)		450 (17.7)	500 (19.6)	132kg/291 lb					

※1...For mounting holes of 6B and 10B, please contact us. ※The handle is a hexagonal wrench key.

BLOCKS FOR MC
VACUUM CHUCKS

Model SKM RECTANGULAR CHUCK TYPE

PROMELTA SYSTEM
SINE BAR CHUCKS
MAGNETIC BLOCKS
WORKING TOOLS
MEASURING TOOL HOLDERS
MAGNETIC HOLDERS
MAGNETIC TOOLS



SKM-1325

An example of mounting

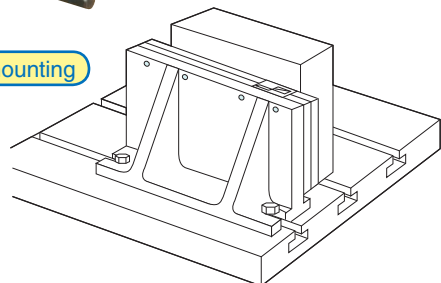

[Application]

These chucks can be used in such applications that when securing a workpiece on the table of a machine, it needs to be held vertically due to its shape or it needs to be secured from sides additionally when it cannot be held sufficiently horizontally.

[Features]

- The permanent magnetic chuck used in the SKM is our powerful RMT, rare earth magnetic chuck.
- Holds various sizes of workpieces: thin, small, and thick.

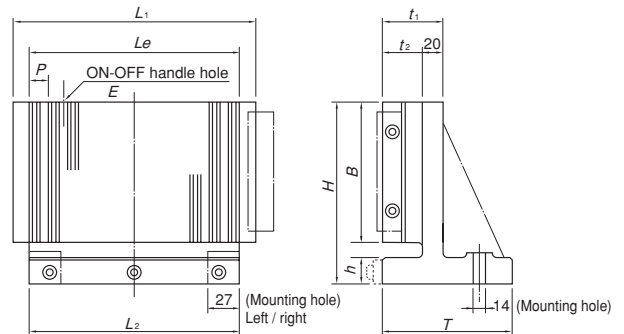

[mm (in)]

Model	Nominal Dimensions	Top Plate			Pole pitch P	Bottom Plate		Thickness		Height		Handle Hole Hexagon 8 (0.31)	Mass
		B	L ₁	L _e		T	L ₂	t ₁	t ₂	H	h		
SKM-1018	100 (3.93) × 175 (6.89)	100 (3.93)	175 (6.89)	137 (5.39)	14.5 (1.5+3.2+1.5+8.3) 0.57 (0.05+0.12+0.05+0.32)	130 (5.11)	145 (5.70)	70 (2.75)	50 (1.96)	130 (5.11)	20 (0.78)	13kg/28 lb	
SKM-1325	125 (4.92) × 250 (9.84)	125 (4.92)	250 (9.84)	209 (8.22)		210 (8.26)	260 (10.2)	160 (6.29)	180 (7.08)	22kg/48 lb			
SKM-1530	150 (5.90) × 300 (11.8)	150 (5.90)	300 (11.8)	253 (9.96)		260 (10.2)	300 (11.8)	260 (10.2)	30kg/66 lb				

※ One set of stoppers is included. The L-shaped handle is included.