

Model RMT-ED JET HOLE TYPE



RMT-ED2525

[Application]

These chucks are designed for securing workpieces during electric discharge machining.

[Features]

- Can be used in fluid.
- With extra powerful holding, these chucks are suited to be used in applications where conventional, standard chucks cannot be used.
- A jetting hole is provided in the center for flushing and removal.
- The bottom face is made flat to allow tapping and clamping.
- Counter boring around the jet holes on the attractive face is possible.
- Improved water-tightness.

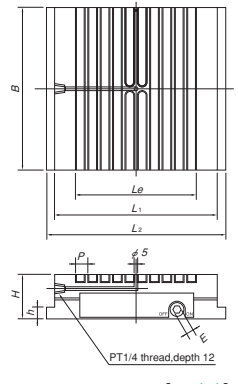

[mm (in)]

Model	Nominal Dimensions	Top Plate			Pole pitch <i>P</i>	Bottom Plate			Thickness <i>H</i>	Handle Hole <i>E</i>	Mass
		<i>B</i>	<i>L</i> ₁	<i>L</i> _e		<i>B</i>	<i>L</i> ₂	<i>h</i>			
RMT-ED2020	200 (7.87) × 200 (7.87)	200 (7.87)	200 (7.87)	149 (5.86)	15.2 (1.5+9+1.5+3.2)	200 (7.87)	220 (8.66)	15 (0.59)	55 (2.16)	Hexagon 8	16kg/35 lb
RMT-ED2525	250 (9.84) × 250 (9.84)	250 (9.84)	250 (9.84)	210 (8.26)	0.59 (0.05+0.35+0.05+0.12)	250 (9.84)	270 (10.6)			(0.31)	23kg/51 lb

※ The chucks come with a hexagonal key wrench handle. ※ An electromagnetic type (special type) is also available. Please contact us.

Model RMWH-ED EDM TYPE

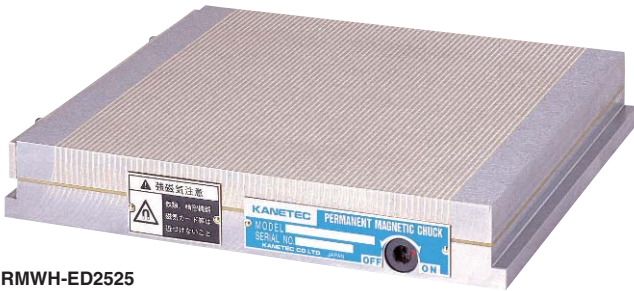

RMWH-ED2525

[Application]

These chucks are suitable for securing workpieces during electric discharge machining.

[Features]

- Can be used in fluid.
- The use of fine pole pitches works very well with thin and small workpieces.
- The bottom is made flat to allow tapping for clamping metal.
- Water-tightness has been improved from the standard type.

An example of usage

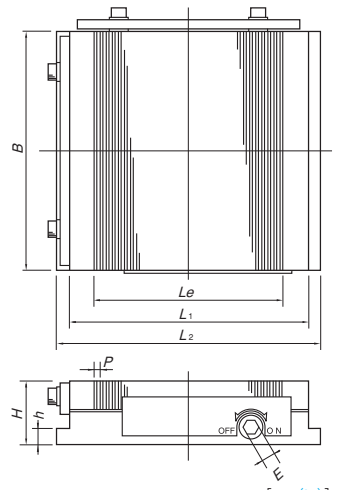
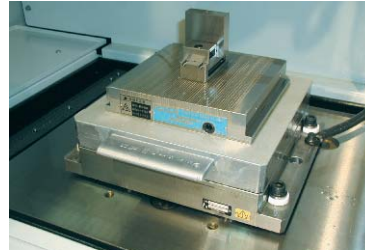

[mm (in)]

Model	Nominal Dimensions	Top Plate			Pole pitch <i>P</i>	Bottom Plate			Thickness <i>H</i>	Handle Hole <i>E</i>	Mass
		<i>B</i>	<i>L</i> ₁	<i>L</i> _e		<i>B</i>	<i>L</i> ₂	<i>h</i>			
RMWH-ED1515	150 (5.90) × 150 (5.90)	150 (5.90)	150 (5.90)	118 (4.64)	3 (1+2)	150 (5.90)	166 (6.53)	10 (0.39)	40 (1.57)	Hexagon 8	7.5kg/16 lb
RMWH-ED2020	200 (7.87) × 200 (7.87)	200 (7.87)	200 (7.87)	160 (6.29)	0.11 (0.03+0.07)	200 (7.87)	216 (8.50)			(0.31)	13kg/28 lb
RMWH-ED2525	250 (9.84) × 250 (9.84)	250 (9.84)	250 (9.84)	208 (8.18)		250 (9.84)	266 (10.4)				20kg/44 lb

※ The chucks come with a hexagonal key wrench handle.

Model RMC-ED JET HOLE AND CIRCULAR TYPE

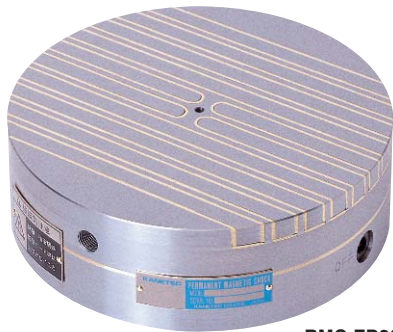

RMC-ED20

[Application]

These chucks are suitable for securing work-pieces in electro discharge machining.

[Features]

- Can be used in fluid.
- With extra powerful holding, these chucks are suited to be used in applications where conventional, standard chucks cannot be used.
- A jetting hole is provided in the center for flushing and removal.
- The bottom face is made flat to allow tapping and clamping.
- Counter boring around the jet holes on the attractive face is possible.

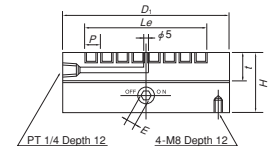
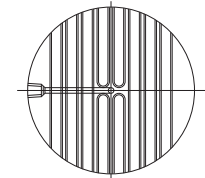

[mm (in)]

Model	Nominal Dimensions	Top Plate		Pole pitch <i>P</i>	Face Plate Thickness <i>t</i>	Height <i>H</i>	Handle Hole <i>E</i>	Mass
		<i>D</i> ₁	<i>L</i> _e					
RMC-ED16	160 (6.29)	160 (6.29)	118 (4.64)	15.2 (1.5+3.2+1.5+9)	29 (1.14)	60 (2.36)	Hexagon 8	8.5kg/18 lb
RMC-ED20	200 (7.87)	200 (7.87)	149 (5.86)	0.59 (0.05+0.12+0.05+0.35)			(0.31)	14kg/31 lb

※ The chucks come with a hexagonal key wrench handle.

ELECTROMAGNETIC CHUCK CONTROLLERS
CHUCK CONTROLLERS
PERMANENT MAGNETIC CHUCKS
ELECTROMAGNETIC CHUCKS
PERMANENT MAGNETIC CHUCKS
ELECTROMAGNETIC CHUCKS
BLOCKS FOR MC
VACUUM CHUCKS
PROMELTA SYSTEM
SINE BAR CHUCKS
MAGNETIC BLOCKS
WORKING TOOLS
MEASURING TOOL HOLDERS
MAGNETIC HOLDERS
MAGNETIC TOOLS