

Model KM MAGNETIC HOLDER



Painting

Model	OD × Height	Holding Power	Facial Treatment	Tapped Hole	Machinable Lange				Max. Temperature	Tapping	Mass
					D ₁	D ₂	H ₁	H ₂			
KM-025C	φ26(1.02) × 25(0.98)	100N(10kgf)	Painting	M6(0.23), depth 8(0.31)	26(1.02)	25(0.98)	25(0.98)	17(0.66)	Type C	Provided	90g/0.19 lb
KM-03C	φ30(1.18) × 25(0.98)	150N(15kgf)		M6(0.23), depth 8(0.31)	30(1.18)	27(1.06)	25(0.98)	17(0.66)			121g/0.26 lb
KM-04C	φ40(1.57) × 30(1.18)	300N(30kgf)		M8(0.31), depth 12(0.47)	40(1.57)	36(1.41)	30(1.18)	20(0.78)			260g/0.57 lb
KM-05C	φ50(1.96) × 40(1.57)	500N(50kgf)		M8(0.31), depth 12(0.47)	50(1.96)	46(1.81)	40(1.57)	25(0.98)	545g/1.20 lb		
KM-025S	26(1.02) × 26(1.02) × 25(0.98)	100N(10kgf)		None	26(1.02)	25(0.98)	25(0.98)	15(0.59)	Prepared hole up to 3.0 deep possible on the back	118g/0.26 lb	
KM-06S	26(1.02) × 60(2.36) × 25(0.98)	200N(20kgf)		M6(0.23), depth 10(0.39)	60(2.36)						Provided

※The holding power applies to SS400, thickness 10mm and ground surface.

Model KM-T-T HEAT-RESISTING MAGNETIC HOLDER

↑ Upper red arrow indicates attractive force.

Announcing a new heat resistant type permanent magnetic holder.

[Application]

It is suitable to be used as Fixing Jig for such working site as in ship building or welding where heat is generated. In addition, it can be used to fix drawing, scale, small parts.

[Features]

- Heat resistance specifications up to 350°C to use.
- Screw holes are provided on its rear face and can be used widely by assembled with jig.



Model	OD×Height	Holding Power	Facial Treatment	Tapped Hole	Max. Temperature	Tapping	Mass
KM-T004T	φ40(1.57) × 40(1.57)	300N(30kgf)	Painting	M8(0.31) depth10(0.39)	MAX. 350°C	Provided	0.4kg/0.88 lb
KM-T005T	φ50(1.96) × 45(1.77)	500N(50kgf)		pitch1.25			0.67kg/1.47 lb

※The holding power applies to SS400, thickness 10mm and ground surface.

Model KM-HT HEAT-RESISTING CLAMP HOLDER

The first release in this business field!

Heat resistance temperature 350 degree C

An example of mounting

heated at 195°C 2 hours by thermo couple fixed on the vertical face.



fixed with mending tape (as it was slid)



Fixed with heat resistance clamp holder

[Application]

Most suitable for wiring small diameter code, code for thermo couple and so on. In addition, it can be used as temporary fixing jig when welding.

[Features]

- Provided with grooves of 3mm, 6mm width on the bottom face, it can be used in accordance with each diameter. (Width and depth can be additionally processed up to 12mm in maximum.)
- By tightening clamping bolt, cord can be fixed without fail.

Model	Magnetic Base	Holding Power	Width of R groove	Power Cord	MasOs
KM-HT05	φ50(1.96) × 35(1.37)	196N(20kgf)	3mm(0.11) / 6mm(0.23)	under φ5(0.19)	Approx. 0.5kg/ 1.10 lb

※The holding power applies to SS400, thickness 10mm and ground surface.

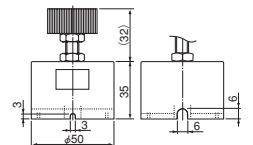

Model KM-RB HEXAGONAL PERMANENT MAGNETIC HOLDER (WITH MALE THREAD)

Model KM-RT HEXAGONAL PERMANENT MAGNETIC HOLDER (WITH PLATE)

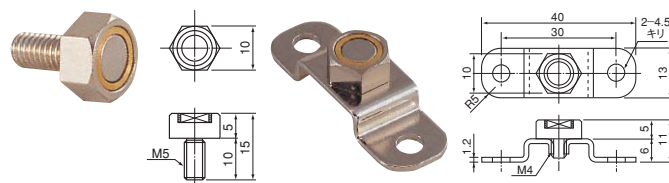

Model	Holding Power	Mass	Model	Holding Power	Mass
KM-RB10	10N(1kgf)	5g/0.011 lb	KM-RT10	10N(1kgf)	10g/0.022 lb
KM-RB14	40N(4kgf)	10g/0.022 lb	KM-RT14	40N(4kgf)	18g/0.039 lb

※The holding power applies to SS400, thickness 10mm and ground surface.

[Application]

This holder is used as a jig.

This holder is used for transporting light workpieces in manufacturing lines, etc.

[Features]

- This holder can be easily attached to any place, since its top end is threaded.
- When used in combination with the plate (type with plate) as an accessory, the holders can be installed in places where tapped holes can not be opened.
- Since this holder is plated with nickel, it can be used under various circumstances.