

Model **KPM** PLATE MAGNET

No ON/OFF function



KPMF-1540A

No ON/OFF function



KPMT-1530

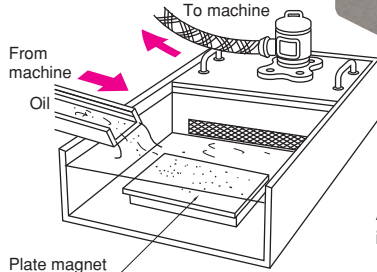

An example of iron-removing magnet in fine particle chute line.

Separated fine iron particles stopped against the flow of materials.

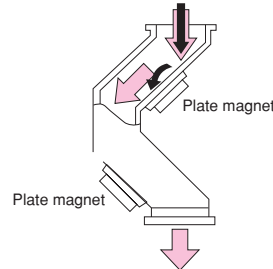
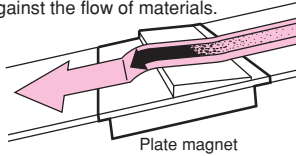

[Application]

These magnets are installed on chutes and hoppers to attract and separate magnetic substances such as iron powder from raw materials used in chemical, drug and other fine particle industries.

[Features]

- Strong attractive force. Compact and robust.
- Easy installation in any place as no power source is required.



Precautions for use

To use these magnets in liquids (e.g. water) other than oil, please specify "enclosed type."

Model **KPMF**

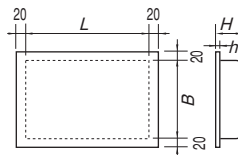

- The whole surface is made of stainless steel (SUS304).
- Large attractive force over a long distance.
- The flange area can be worked partially.

Model **KPMT**

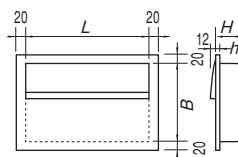

- An iron magnetic plate mounted on the attractive face of Model "F."
- The holding power is applied to the attracted iron pieces by the magnetic plate so that they will not be pushed forward by following materials.

Standard Models

Flat type

[mm (in)]

Model	Dimensions				Holding Capacity (Length)			Mass
	B	L	H	h	15-cm nail	M10 nut	M10×25 bolt	
KPMF-1515A	150 (5.90)	150 (5.90)	42.2 (1.66)	3.2 (0.12)	80—100 (3.15—3.93)	40—60 (1.57—2.36)	60—80 (2.36—3.15)	6kg/ 13.2 lb
KPMF-1530A		300 (11.8)						11kg/ 24.2 lb
KPMF-1535A		350 (13.7)						13kg/ 28.6 lb
KPMF-1540A		400 (15.7)						15kg/ 33.0 lb
KPMF-1545A		450 (17.7)						17kg/ 37.4 lb
KPMF-1550A		500 (19.6)						18kg/ 39.6 lb
KPMF-1560A	600 (23.6)	22kg/ 48.5 lb						
KPMF-2020A	200 (7.87)	200 (7.87)	55.5 (2.18)	3.5 (0.13)	100—130 (3.93—5.11)	60—80 (2.36—3.15)	80—100 (3.15—3.93)	13kg/ 28.6 lb
KPMF-2030A		300 (11.8)						20kg/ 44.0 lb
KPMF-2040A		400 (15.7)						27kg/ 59.5 lb
KPMF-2050A		500 (19.6)						33kg/ 72.7 lb
KPMF-2060A		600 (23.6)						40kg/ 88.1 lb
KPMF-2080A		800 (31.5)						54kg/ 119.0 lb
KPMF-3030A	300 (11.8)	300 (11.8)	120—160 (4.72—6.29)	70—100 (2.75—3.93)	100—120 (3.93—4.72)	29kg/ 63.9 lb		
KPMF-3040A		400 (15.7)				39kg/ 85.9 lb		
KPMF-3050A		500 (19.6)				49kg/ 108.0 lb		
KPMF-3060A		600 (23.6)				59kg/ 130.1 lb		
KPMF-3080A		800 (31.5)				79kg/ 174.2 lb		

Surface magnetic flux density 130 mT (1300 G) max.

With magnetic plate

[mm (in)]

Model	Dimensions				Holding Capacity (Length)			
	B	L	H	h	15-cm nail	M10 nut	M10×25 bolt	Mass
KPMT-1515	150 (5.90)	150 (5.90)	43.5 (1.71)	3.2 (0.12)	80—100 (3.15—3.93)	40—60 (1.57—2.36)	60—80 (2.36—3.15)	7kg/ 15.0 lb
KPMT-1530		300 (11.8)						12kg/ 26.4 lb
KPMT-1540		400 (15.7)						16kg/ 35.2 lb
KPMT-1550		500 (19.6)						20kg/ 44.0 lb
KPMT-1560		600 (23.6)						24kg/ 52.9 lb
KPMT-2020		200 (7.87)						14kg/ 30.8 lb
KPMT-2030	200 (7.87)	300 (11.8)	56.5 (2.22)	3.5 (0.13)	100—130 (3.93—5.11)	60—80 (2.36—3.15)	80—100 (3.15—3.93)	21kg/ 46.3 lb
KPMT-2040		400 (15.7)						29kg/ 63.9 lb
KPMT-2050		500 (19.6)						35kg/ 77.1 lb
KPMT-2060		600 (23.6)						42kg/ 92.5 lb
KPMT-3030		300 (11.8)						32kg/ 70.5 lb
KPMT-3040		400 (15.7)						42kg/ 92.5 lb
KPMT-3050	300 (11.8)	500 (19.6)	120—160 (4.72—6.29)	70—100 (2.75—3.93)	100—120 (3.93—4.72)	53kg/ 116.8 lb		
KPMT-3060		600 (23.6)				63kg/ 138.9 lb		
KPMT-3080		800 (31.5)				84kg/ 185.2 lb		

Surface magnetic flux density 250 mT (2500 G) max.

Powerful type Powerful plate magnets using rare earth magnets

Flat type

[mm (in)]

Model	Dimensions				Holding Capacity (Length)			Mass
	B	L	H	h	15-cm nail	M10 nut	M10×25 bolt	
KPMF-H1510	150 (5.90)	100 (3.93)	25 (0.98)	3.2 (0.12)	100—130 (3.93—5.11)	60—80 (2.36—3.15)	80—100 (3.15—3.93)	3.0kg/ 6.61 lb
KPMF-H1515		150 (5.90)						4.5kg/ 9.92 lb
KPMF-H1520		200 (7.87)						5.5kg/ 12.1 lb
KPMF-H1530		300 (11.8)						8.5kg/ 18.0 lb
KPMF-H2020		200 (7.87)						8.0kg/ 17.6 lb
KPMF-H2025		200 (7.87)						250 (9.84)
KPMF-H2030	300 (11.8)		11.5kg/ 25.0 lb					
KPMF-H2040	400 (15.7)		15.5kg/ 34.1 lb					

Surface magnetic flux density 130 mT (1300 G) max.

With magnetic plate

[mm (in)]

Model	Dimensions				Holding Capacity (Length)			
	B	L	H	h	15-cm nail	M10 nut	M10×25 bolt	Mass
KPMT-H1510	150 (5.90)	100 (3.93)	25 (0.98)	3.2 (0.12)	100—130 (3.93—5.11)	60—80 (2.36—3.15)	80—100 (3.15—3.93)	4.0kg/ 8.80 lb
KPMT-H1515		150 (5.90)						6.0kg/ 13.2 lb
KPMT-H1520		200 (7.87)						8.0kg/ 17.6 lb
KPMT-H1530		300 (11.8)						12.0kg/ 26.4 lb
KPMT-H2020		200 (7.87)						10.0kg/ 22.0 lb
KPMT-H2025		200 (7.87)						250 (9.84)
KPMT-H2030	300 (11.8)		15.0kg/ 33.0 lb					
KPMT-H2040	400 (15.7)		20.0kg/ 44.0 lb					

Surface magnetic flux density 500 mT (5000 G) max.

※Magnets with handle and hinge are optionally available upon request.

MAGNETIC TOOLS FOR WELDING OPERATION

LIFTING MAGNET

MAGBORE

CHIP & SLUDGE TRANSPORTERS

ENVIRONMENTAL EQUIPMENT

MAGNETIZERS AND DEMAGNETIZERS

MAGNETIC EQUIPMENT FOR TRANSPORTATION

MAGNETIC SEPARATORS

HIGH-GRADE MAGNETIC SEPARATORS

MEASURING TOOLS

MEASURING INSTRUMENTS

MAGNETIC MATERIALS