

HIGH GRADE MAGNETIC SEPARATORS

Model PCMP POWERFUL CLEAN MAGNETIC PIPE

MAGNETIC TOOLS FOR WELDING OPERATION
LIFTING MAGNET
MAGBORE

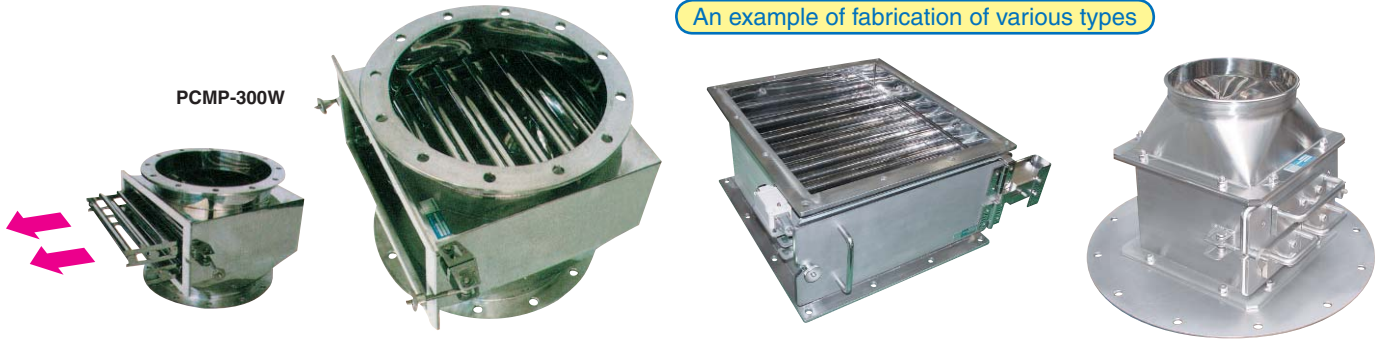

An example of fabrication of various types

An example of PCMP automatic discharge type

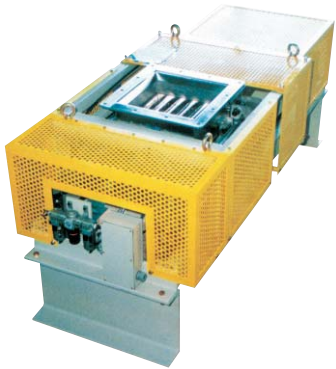

[Application]

These pipes are installed on the falling side of pneumatic feed lines and pipe passages having a relatively large diameter to remove iron from flowing bulk materials of food raw materials and chemical powder.

[Features]

- Models of various sizes are available according to diameters of pipes on which they are installed and required processing capacity.
 - Powerful magnetic bars having a surface magnetic flux density of 0.8 T (8,000 G) or 1 T (10,000 G) or over are built in, that realizes superb performance in collecting iron mixed in flowing bulk materials.
 - A heat-resistant powerful version that can maintain a strong magnetic force without significant deterioration when used continuously in fluids up to 240°C is also available.
 - Since permanent magnets of which the strong magnetic force is maintained for almost perpetually are used, the running cost can be reduced significantly.
- An example of application: Spice raw materials, gunpowder, chemicals

Gentle removal of iron from powder, fine and coarse particles without damaging or denaturing them.

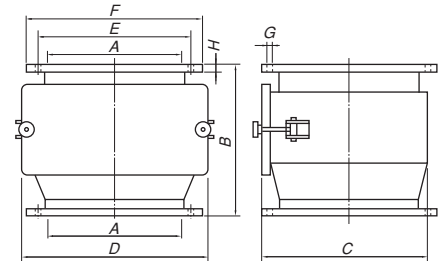

Powerful type

Model	Material	Magnetic Bar		Capacity	External Dimensions								Working Temperature Upper Limit	Mass	
		Stage	Pcs Mounted		A	B	C	D	E	F	G	H			
PCMP-200W	SUS 304	2	9	0.8T (8000G)	6m ³ /h	φ 220 (8.66)	360 (14.1)	269 (10.5)	296 (11.6)	280 (11.0)	320 (12.6)	φ 18 (0.70) × 8 (0.31)	8 (0.31)	80°C (176°F)	24kg/ 52 lb
PCMP-250W			10m ³ /h		φ 270 (10.6)	380 (14.9)	319 (12.5)	346 (13.6)	345 (13.5)	385 (15.2)	30kg/ 66 lb				
PCMP-300W			14m ³ /h		φ 320 (12.6)	410 (16.1)	369 (14.5)	396 (15.5)	390 (15.3)	430 (16.9)	φ 18 (0.70) × 12 (0.47)	35kg/ 77 lb			
PCMP-350W			18m ³ /h		φ 370 (14.5)	450 (17.7)	419 (16.5)	446 (17.5)	435 (17.1)	480 (18.9)		41kg/ 90 lb			
PCMP-400W			24m ³ /h		φ 420 (16.5)	470 (18.5)	469 (18.4)	496 (19.5)	495 (19.4)	540 (21.2)	φ 18 (0.70) × 16 (0.62)	47kg/ 103 lb			

※Flanges of special dimensions are also available according to the specifications of connection. ※A type having the magnet part made of SUS316 and a type having one-stage magnet rack are also available.

Heat-resistant powerful type

Model	Material	Magnetic Bar		Capacity	External Dimensions								Working Temperature Upper Limit	Mass	
		Stage	Pcs Mounted		A	B	C	D	E	F	G	H			
PCMP-T200W	SUS 304	2	9	0.8T (8000G)	6m ³ /h	φ 220 (8.66)	360 (14.1)	269 (10.5)	296 (11.6)	280 (11.0)	320 (12.6)	φ 18 (0.70) × 8 (0.31)	8 (0.31)	240°C (464°F)	24kg/ 52 lb
PCMP-T250W			10m ³ /h		φ 270 (10.6)	380 (14.9)	319 (12.5)	346 (13.6)	345 (13.5)	385 (15.2)	30kg/ 66 lb				
PCMP-T300W			14m ³ /h		φ 320 (12.6)	410 (16.1)	369 (14.5)	396 (15.5)	390 (15.3)	430 (16.9)	φ 18 (0.70) × 12 (0.47)	35kg/ 77 lb			
PCMP-T350W			18m ³ /h		φ 370 (14.5)	450 (17.7)	419 (16.5)	446 (17.5)	435 (17.1)	480 (18.9)		41kg/ 90 lb			
PCMP-T400W			24m ³ /h		φ 420 (16.5)	470 (18.5)	469 (18.4)	496 (19.5)	495 (19.4)	540 (21.2)	φ 18 (0.70) × 16 (0.62)	47kg/ 103 lb			

※Flanges of special dimensions are also available according to the specifications of connection. ※A type having the magnet part made of SUS316 and a type having one-stage magnet rack are also available.

Super powerful type

Model	Material	Magnetic Bar		Capacity	External Dimensions								Working Temperature Upper Limit	Mass	
		Stage	Pcs Mounted		A	B	C	D	E	F	G	H			
PCMP-A200W	SUS 304	2	9	1T (10000G)	6m ³ /h	φ 220 (8.66)	360 (14.1)	269 (10.5)	296 (11.6)	280 (11.0)	320 (12.6)	φ 18 (0.70) × 8 (0.31)	8 (0.31)	80°C (176°F)	24kg/ 52 lb
PCMP-A250W			10m ³ /h		φ 270 (10.6)	380 (14.9)	319 (12.5)	346 (13.6)	345 (13.5)	385 (15.2)	30kg/ 66 lb				
PCMP-A300W			14m ³ /h		φ 320 (12.6)	410 (16.1)	369 (14.5)	396 (15.5)	390 (15.3)	430 (16.9)	φ 18 (0.70) × 12 (0.47)	35kg/ 77 lb			
PCMP-A350W			18m ³ /h		φ 370 (14.5)	450 (17.7)	419 (16.5)	446 (17.5)	435 (17.1)	480 (18.9)		41kg/ 90 lb			
PCMP-A400W			24m ³ /h		φ 420 (16.5)	470 (18.5)	469 (18.4)	496 (19.5)	495 (19.4)	540 (21.2)	φ 18 (0.70) × 16 (0.62)	47kg/ 103 lb			

※Flanges of special dimensions are also available according to the specifications of connection. ※A type having the magnet part made of SUS316 and a type having one-stage magnet rack are also available.

HIGH GRADE MAGNETIC SEPARATORS
MEASURING TOOLS
MEASURING INSTRUMENTS
MAGNETIC MATERIALS

CHIP & SLUDGE TRANSPORTERS
ENVIRONMENTAL EQUIPMENT

MAGNETIZERS AND DEMAGNETIZERS
FOR TRANSPORTATION
SEPARATORS